



Mansard  
House

**South Meadow Road**  
St Crispin, Northampton

oriordanbond  
LETTINGS





GROUND FLOOR  
657 sq.ft. (61.1 sq.m.) approx.

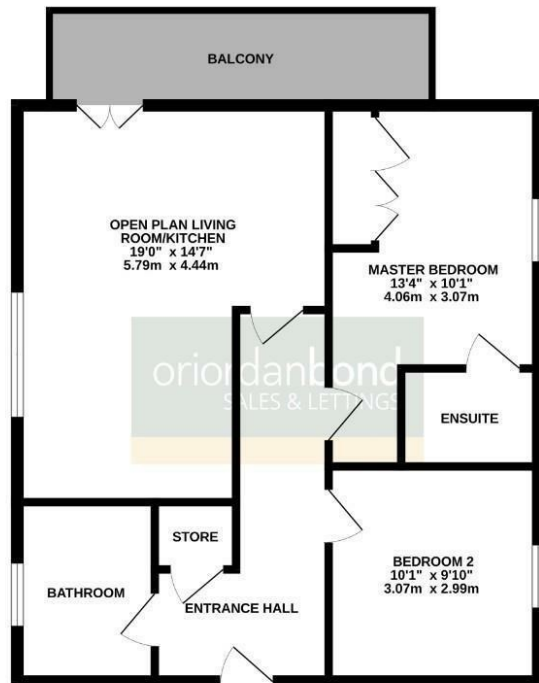

15 MANSARD HOUSE, ST CRISPINS

TOTAL FLOOR AREA: 657 sq.ft. (61.1 sq.m.) approx.

While every attempt has been made to ensure the accuracy of the floorplan contained here, measurements of doors, windows, rooms and any other items are approximate and no responsibility is taken for any error, omission or misstatement. This plan is for illustrative purposes only and should be used as such by any prospective purchaser. The services, systems and appliances shown have not been tested and no guarantee as to their operability or efficiency can be given.  
Made with Metreplan (CIS6)

## South Meadow Road

St Crispin

NN5 4RG

£950 PCM

Situated in the sought-after St.Crispin development and presented in immaculate condition throughout. The two-bedroom first-floor apartment comprises an entrance hall, an open-plan lounge/kitchen diner with appliances, and access to a large balcony. It also features a master bedroom with fitted wardrobes and an En-suite, a second double bedroom with fitted wardrobes, and a family bathroom. Further benefits include allocated gated parking.

### Tenancy Information

- Deposit: £1096.00 (1 Week Holding Deposit - £219.00)
- Smokers: Not Allowed
- Unfurnished
- Water Rates: £40 per month charge
- Length of Tenancy: 12 Months
- Available: Mid January 2026

### Additional information

- Council Tax Band: C
- Energy Efficiency Rating: C

### Viewing

Viewing strictly by appointment – details below

### Disclaimer

O'Riordan Bond Estate Agents Limited has not tested apparatus, equipment, fittings or services and so cannot verify they are in working order. The buyer is advised to obtain verification from their solicitor or surveyor.

O'Riordan Bond Weston Favell Lettings

01604 814400

lettingswestonfavell@oriordanbond.co.uk

